

Chemin de câbles fil
(Mesh tray)

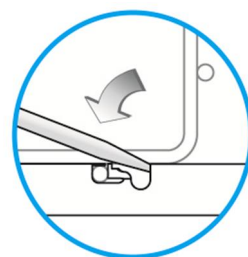

Description	Code	Masse/Weight Kg/p	Ep./Th. mm	H mm	l./w. mm
ZUF 150 U I2	554147	0,122	1,50	22	145

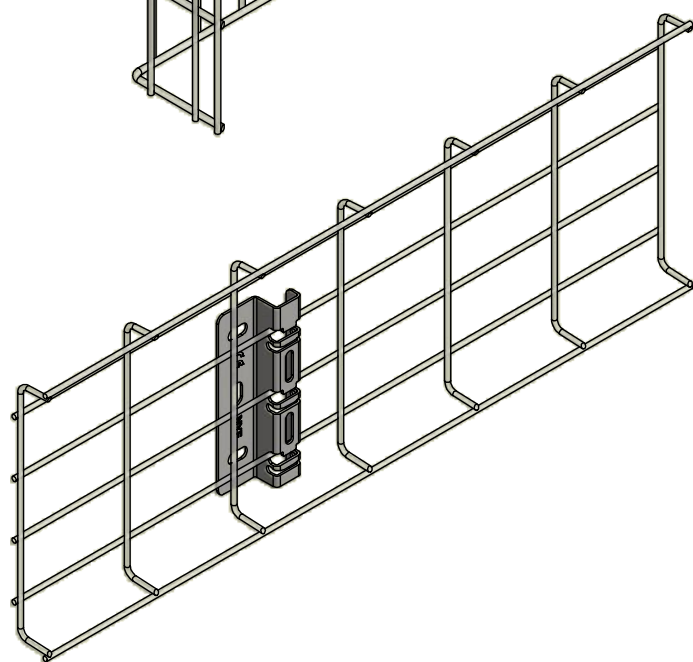
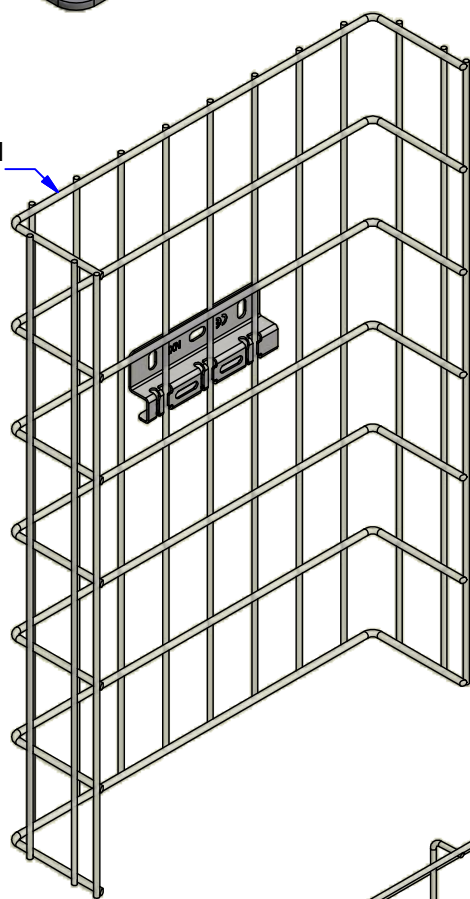
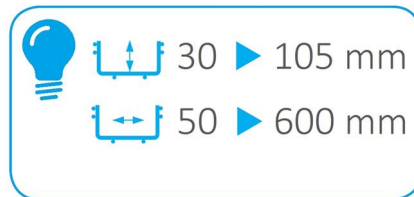

www.niedaxfrance.fr

SS304L : Stainless steel according to NF EN 10088-2 (304L).
I2 : Tôle d'acier inoxydable suivant NF EN 10088-2 (304L).

ZED FIXATION ZUF 150 U I2
 ZUF 150U CLIP-ON BRACKET SS304L



ASSISTANCE TECHNIQUE
 +33 (0)1 55 95 92 17
 pole.technique@niedax.fr

FT02884

NIEDAX
 France

